

SIDE VIEW
SCALE: 1/2" = 1'-0"

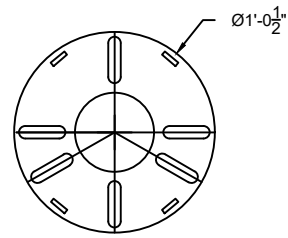

CAST ALUMINUM PLATE, 6 SLOT UNIVERSAL 3 OR 4 BOLT
 VARIABLE 9 1/2" - 12 1/2" BOLT CIRCLE FOR 3/4" ANCHOR BOLTS

BOLT CIRCLE
SCALE: 1" = 1'-0"

GLOSS BLACK
 POLYURETHANE
 PAINT STANDARD.
 OTHER COLORS
 AVAILABLE.

NOTES

1. WIND SPEED 120 MPH
2. WIND LOADING 1.65
3. POLE WEIGHT 135 LBS.

A	CREATED	JAH	05/18/17
B			
C			
REV:	DESCRIPTION:	BY:	DATE:

AMENDMENTS:

TITLE:	FIBERGLASS-FLUTED-TAPERED	SCALE AT A4. 1/2"=1'-0"	DRAWN. JAH	CHECKED. XXX	REVISION. A
--------	---------------------------	----------------------------	---------------	-----------------	----------------

STYLE:	WINDSOR-17	PART NO. AF803	PROJECT NO. XX	DATE. 05/18/17
--------	------------	-------------------	-------------------	-------------------



MAIN STREET LIGHTING

1080 INDUSTRIAL PKWY.
 MEDINA, OH 44256
 www.mainstreetlighting.com/