

**SIDE VIEW** 1  
**SCALE: 1/2" = 1'-0"**

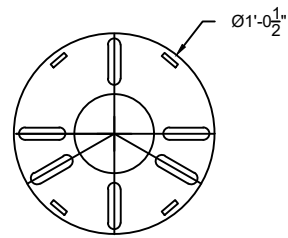

CAST ALUMINUM PLATE, 6 SLOT UNIVERSAL 3 OR 4 BOLT  
 VARIABLE 9 1/2" - 12 1/2" BOLT CIRCLE FOR 3/4" ANCHOR BOLTS

**BOLT CIRCLE** 2  
**SCALE: 1" = 1'-0"**

GLOSS BLACK  
 POLYURETHANE  
 PAINT STANDARD.  
 OTHER COLORS  
 AVAILABLE.

**NOTES**

1. WIND SPEED 120 MPH
2. WIND LOADING 0.92
3. POLE WEIGHT 144 LBS.

A	CREATED	JAH	05/18/17
B			
C			
REV:	DESCRIPTION:	BY:	DATE:
AMENDMENTS:			

TITLE: <b>FIBERGLASS-FLUTED-TAPERED</b>	SCALE AT A4. 1/2"=1'-0"	DRAWN. JAH	CHECKED. XXX	REVISION. A
--	----------------------------	---------------	-----------------	----------------

STYLE: <b>WINDSOR-17</b>	PART NO. FF804	PROJECT NO. XX	DATE. 05/18/17
-----------------------------	-------------------	-------------------	-------------------



**MAIN STREET LIGHTING**

1080 INDUSTRIAL PKWY.  
 MEDINA, OH 44256  
 www.mainstreetlighting.com/